

**FL-S002-A** SM-Carbon Fwd-lean Set

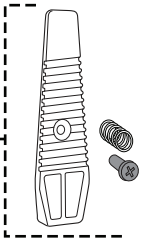

**HB-S002-A** Carbon S Ultraback Hiback Set w/ Fwd-lean (FL-S002-A) + Hware set (HW-S002-A)

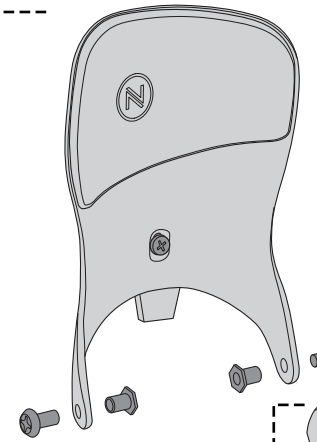

**HW-S002-A (S35-A1)** Hiback C-bolt Set T-nuts + Screws (M5\*8)



**BP-S002-A** SM Carbon Heelcup + Pedal + Ladderstraps Pre-mounted Set

**VP-S003-A** Locking-Pins w/ Link-back screws (M5\*16) HW-S003-A

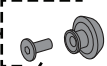

**HW-S003-A (S30-B1)** Link Back Screw (M5\*16)

**BP-S003-A (S01-R1)** Roller Set + Axle + Hware (M5\*12) HW-S004-A

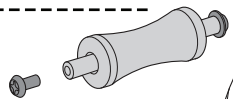

**HW-S004-A (S30-C1)** Hiback-Axle Screw (M5\*12)

**AL-N002-A** LSR2.0 Ankle-Pivot-Ladder

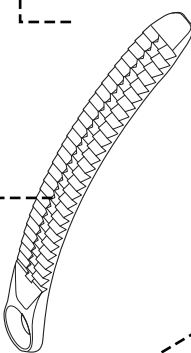

**VP-S002-A (S27-C3)** SM Baseplate cover-washer w/ screws

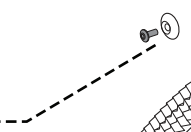

**TL-N003-A** LSR2.0 Straight Toe-ladder w/ plug (LP-N001-A)

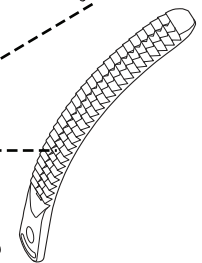

**LP-N001-A (20-A1)** Ladderstrap Plugs



**HW-N008-A (42-G1)** Mounting screws (M6\*14.5)

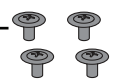

**MD-N001-A (21-H2)** Multi-Disk Mounting disk w/ screws (M6\*14.5) HW-N008-A



LSR2.0 Carbon Ankle-ratchet w/ screws (HW-N007-A) **AB-N004-A**

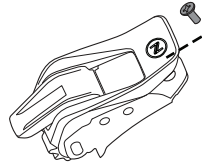

ExoKush Pro S Hybrid-straps Set w/ Diagonal Ladder Leanblock (HS-S002-A) **HS-S003-A**

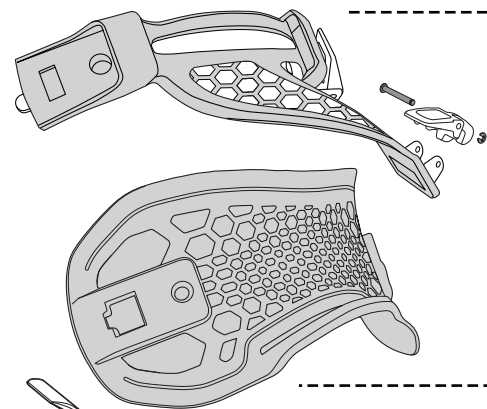

QuickSet Pivot Ankle-ladder **AQ-N001-A (17-G1)**



LSR2.0 Carbon Toe-ratchet w/ screws (HW-N006-A) **TB-N004-A**

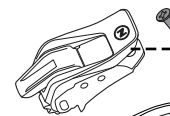

SM Hexo AuxTech Toecap Set w/ QS-latch **TS-S001-A (S11-A1)**

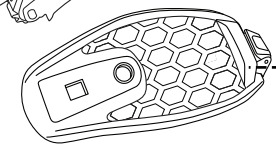

Hook Release-lever w/ screws **VP-S001-A (S27-L3)**

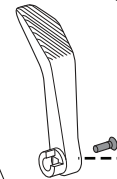

Diagonal Ladder Leanblock Q-Set Latch **HS-S002-A (S13-D1)**

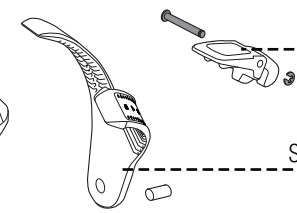

SM QuickSet Y-Toeladder w/ plug **YQ-S001-A (S17-H1)**

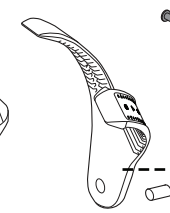

Footbed screws (M5\*10) **HW-S001-A (S40-B1)**

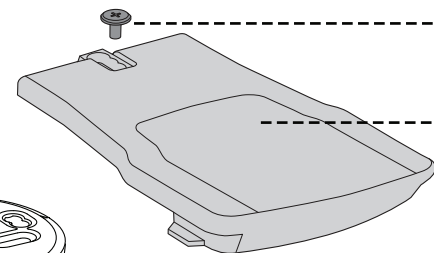

SM-Carbon Slip-N-Grip Footbed Set w/ screws (M5\*10) HW-S001-A **FB-S002-A**



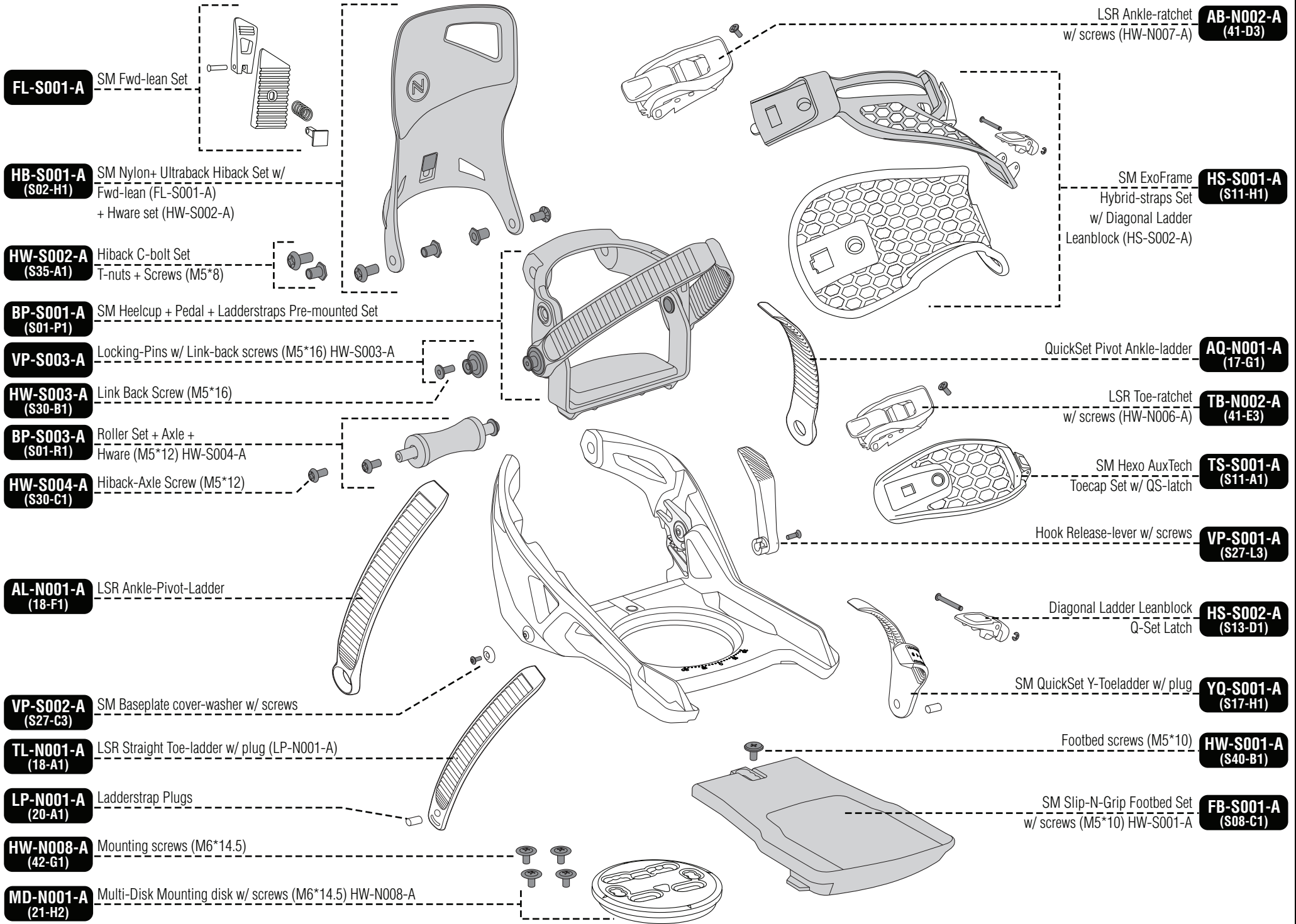

**FL-S001-A** SM Fwd-lean Set

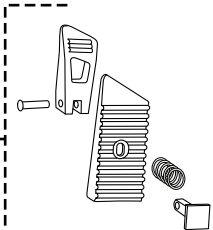

**HB-S001-A (S02-H1)** SM Nylon+ Ultraback Hiback Set w/ Fwd-lean (FL-S001-A) + Hware set (HW-S002-A)

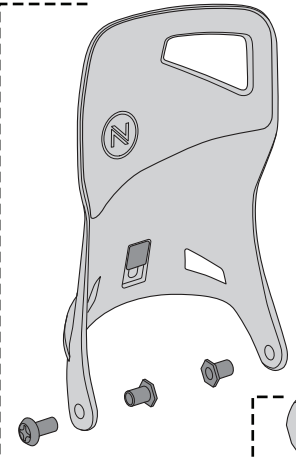

**HW-S002-A (S35-A1)** Hiback C-bolt Set T-nuts + Screws (M5\*8)

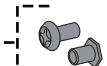

**BP-S001-A (S01-P1)** SM Heelcup + Pedal + Ladderstraps Pre-mounted Set

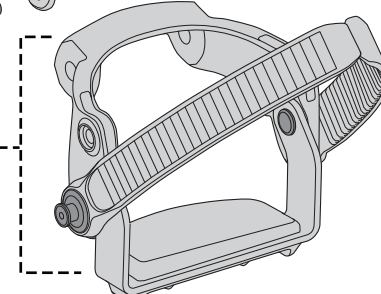

**VP-S003-A** Locking-Pins w/ Link-back screws (M5\*16) HW-S003-A

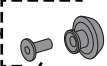

**HW-S003-A (S30-B1)** Link Back Screw (M5\*16)

**BP-S003-A (S01-R1)** Roller Set + Axle + Hware (M5\*12) HW-S004-A

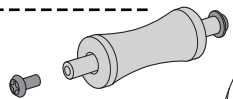

**HW-S004-A (S30-C1)** Hiback-Axle Screw (M5\*12)



LSR Ankle-ratchet w/ screws (HW-N007-A) **AB-N002-A (41-D3)**

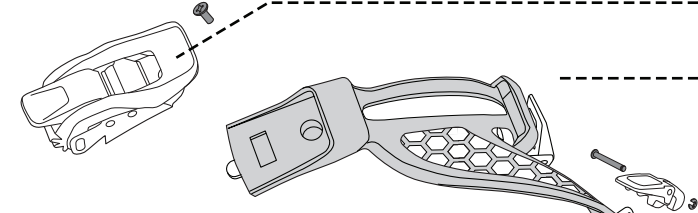

SM ExoFrame Hybrid-straps Set w/ Diagonal Ladder Leanblock (HS-S002-A) **HS-S001-A (S11-H1)**

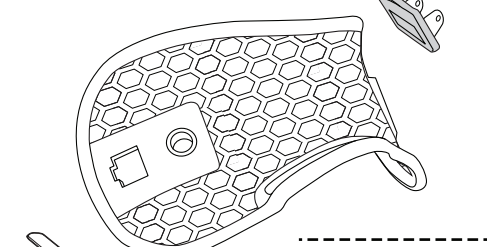

QuickSet Pivot Ankle-ladder **AQ-N001-A (17-G1)**



LSR Toe-ratchet w/ screws (HW-N006-A) **TB-N002-A (41-E3)**

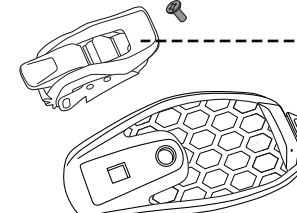

SM Hexo AuxTech Toecap Set w/ QS-latch **TS-S001-A (S11-A1)**

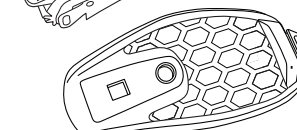

Hook Release-lever w/ screws **VP-S001-A (S27-L3)**

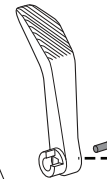

**AL-N001-A (18-F1)** LSR Ankle-Pivot-Ladder

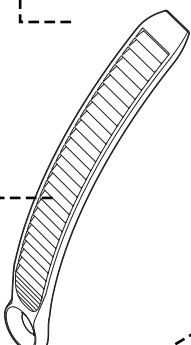

Diagonal Ladder Leanblock Q-Set Latch **HS-S002-A (S13-D1)**

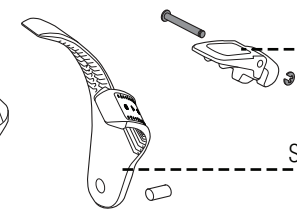

**VP-S002-A (S27-C3)** SM Baseplate cover-washer w/ screws

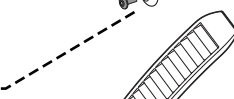

SM QuickSet Y-Toeladder w/ plug **YQ-S001-A (S17-H1)**



**TL-N001-A (18-A1)** LSR Straight Toe-ladder w/ plug (LP-N001-A)

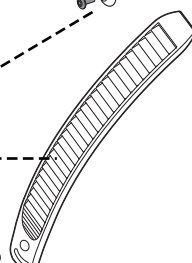

Footbed screws (M5\*10) **HW-S001-A (S40-B1)**

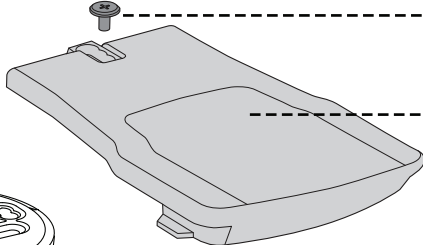

**LP-N001-A (20-A1)** Ladderstrap Plugs



SM Slip-N-Grip Footbed Set w/ screws (M5\*10) HW-S001-A **FB-S001-A (S08-C1)**



**HW-N008-A (42-G1)** Mounting screws (M6\*14.5)

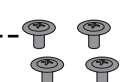

**MD-N001-A (21-H2)** Multi-Disk Mounting disk w/ screws (M6\*14.5) HW-N008-A



**SL-F003-A** Fuse/NX2 Snaplock  
(12-F1) w/ Bolt+Nut Set (HW-F014-A)

**HW-F014-A** Snaplock Mount Bolt+Nut Set  
(48-D2) (for Nylon hiback)

**CS-F004-A** NX2-CX Cable  
(14-01)

**HB-F003-A** Carbon Asym hiback Set  
(02-F4) (= Hiback + EVA + Snaplock Set SL-F003-A + C-bolt Set HW-F003-A)

**AL-N002-A** LSR2.0 Ankle Pivot-Ladder

**HW-F005-A** NX2/Fuse Ankle-ladder Pivot-mount Set  
(38-B2) (= Screw HW-F006-A (M5\*9) + Pivot-washer PW-N001-A + T-nut)

**HW-F003-A** Asym Uniback C-bolt Set  
(28-R2) (= T-nut + Step-Screw (M5\*14.8))

**VP-F002-A** NX2-Cable Mount-Set  
(27-G2) (= Cover + Washers + Tnut + Screw HW-F006-A (M5\*9))

**TL-F002-A** LSR2.0 Straight Toe-ladder w/o plug

**VP-F001-A** NX2 Toeladder Mount-Set  
(34-C2) (= Cover + T-nut + Screw HW-F006-A (M5\*9))

**MD-F003-A** Multi-Disk Alu Mounting Set (= Disk  
(21-G3) + Mount-screws HW-F016-2 (M6\*13))

LSR2.0 Carbon Ankle-ratchet  
w/ screws (HW-N007-A)

**AB-N004-A**

ExoKush 2.0 Fusion  
Straps Set (= Ankle &  
Toe Spines +  
Exo2.0 Frame +  
Kush2.0 EVA +  
QS-latches)

**FS-F005-A**

LSR2.0 Carbon Toe-ratchet  
w/ screws (HW-N007-A)

**TB-N004-A**

EXO Buckle-mounting Screw (M5\*12.5)

**HW-N007-A**  
(24-C1)

QuickSet Pivot Ankle-ladder

**AQ-N001-A**  
(17-G1)

QuickSet Toe-ladder

**TQ-N002-A**  
(17-E1)

NX2 Series Baseplate Set  
(= Baseplate + OC-Kush Basepad)

**BP-F005-A**  
(01-R1)

NX2-Carbon Slip-N-Grip BankBed  
footbed Set

**FB-F002-A**  
(08-H1)

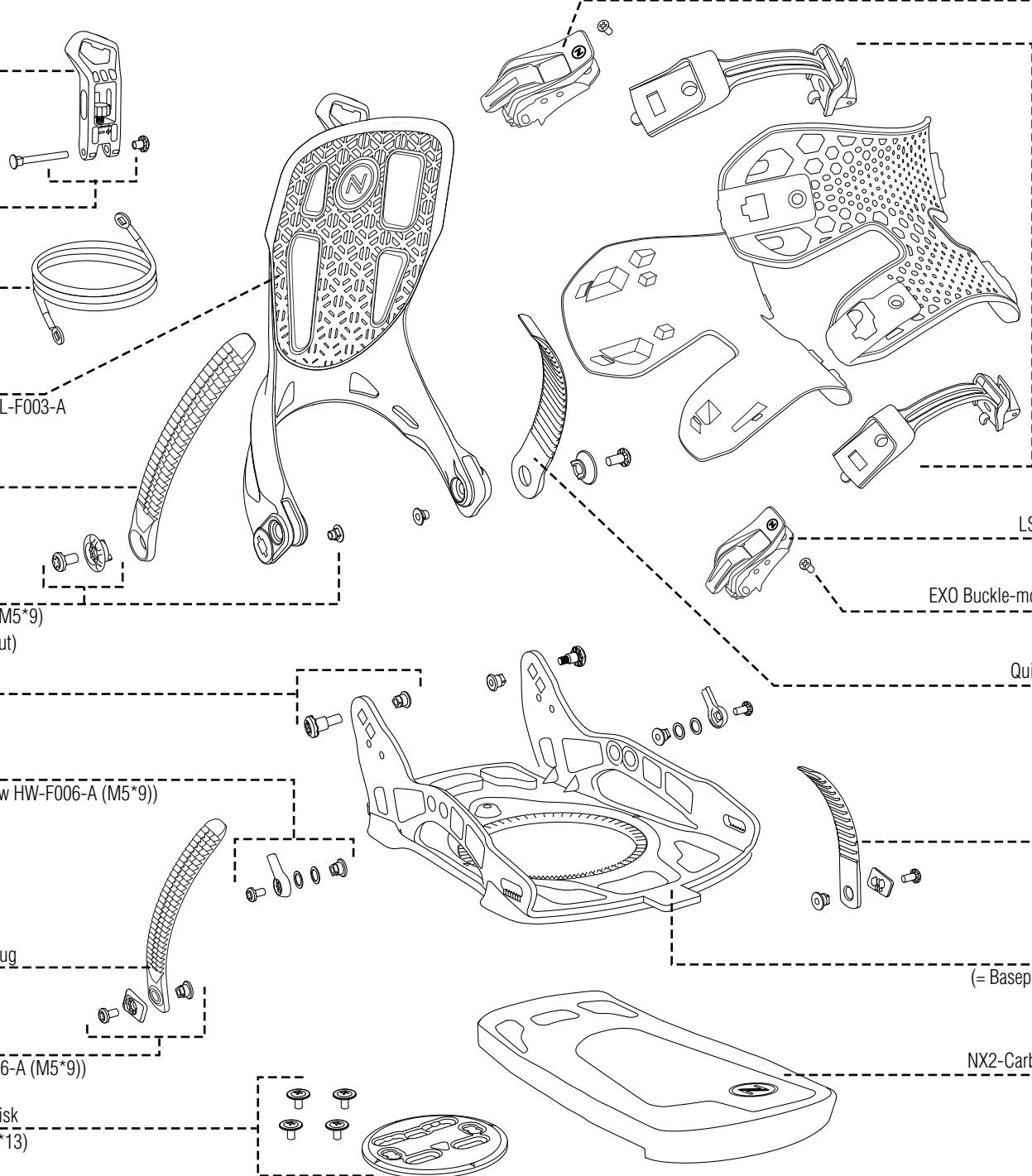

**SL-F003-A** Fuse/NX2 Snaplock  
(12-F1) w/ Bolt+Nut Set (HW-F014-A)

**HW-F014-A** Snaplock Mount Bolt+Nut Set  
(48-D2) (for Nylon hiback)

**CS-F004-A** NX2-CX Cable  
(14-01)

**HB-F003-A** Carbon Asym hiback Set  
(02-F4) (= Hiback + EVA + Snaplock Set SL-F003-A + C-bolt Set HW-F003-A)

**AL-N002-A** LSR2.0 Ankle Pivot-Ladder

**HW-F005-A** NX2/Fuse Ankle-ladder Pivot-mount Set (= Screw HW-F006-A (M5\*9) + Pivot-washer PW-N001-A + T-nut)

**HW-F003-A** Asym Uniback C-bolt Set  
(28-R2) (= T-nut + Step-Screw (M5\*14.8))

**VP-F002-A** NX2-Cable Mount-Set  
(27-G2) (= Cover + Washers + Tnut + Screw HW-F006-A (M5\*9))

**TL-F002-A** LSR2.0 Straight Toe-ladder w/o plug

**VP-F001-A** NX2 Toeladder Mount-Set  
(34-C2) (= Cover + T-nut + Screw HW-F006-A (M5\*9))

**MD-F003-A** Multi-Disk Alu Mounting Set (= Disk + Mount-screws HW-F016-A (M6\*13))

LSR2.0 Carbon Ankle-ratchet w/ screws (HW-N007-A)

**AB-N004-A**

ExoKush 2.0 Hybrid Straps Set (= Hybrid-Spine + Exo2.0 Hybrid-Frame + Kush2.0 Hybrid-EVA + QS-latches)

**HS-N003-A**

QuickSet Pivot Ankle-ladder

**AQ-N001-A**  
(17-G1)

LSR2.0 Carbon Toe-ratchet w/ screws (HW-N006-A)

**TB-N004-A**

Buckle-mounting Screw (M5\*7)

**HW-N006-A**  
(24-B1)

Hexo Toecap w/ QS-latch

**TS-N001-A**  
(11-A1)

QuickSet Y Toeladder

**YQ-N002-A**  
(17-J2)

NX2 Series Baseplate Set (= Baseplate + OC-Kush Basepad)

**BP-F005-A**  
(01-R1)

NX2-Carbon Slip-N-Grip BankBed footbed Set

**FB-F002-A**  
(08-H1)

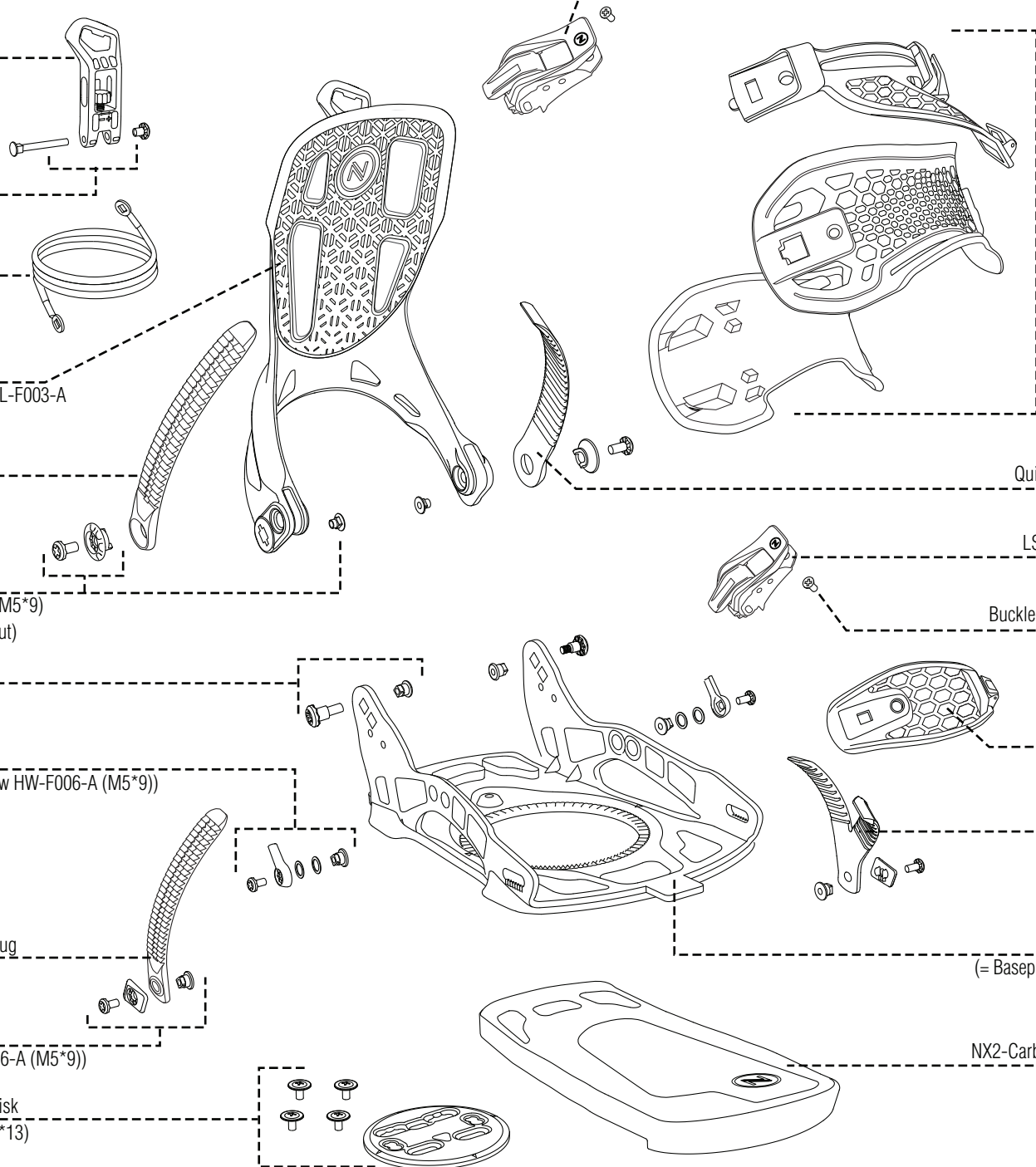



**SL-F003-A** Fuse/NX2 Snaplock  
(12-F1) w/ Bolt+Nut Set (HW-F014-A)

**HW-F014-A** Snaplock Mount Bolt+Nut Set  
(48-D2) (for Nylon hiback)

**CS-F004-A** NX2-CX Cable  
(14-01)

**HB-F002-A** Nylon Asym hiback Set  
(02-F3) (= Hiback + EVA + Snaplock Set SL-F003-A + C-bolt Set HW-F003-A)

**AL-N002-A** LSR2.0 Ankle Pivot-Ladder

**HW-F005-A** NX2/Fuse Ankle-ladder Pivot-mount Set (= Screw HW-F006-A (M5\*9) + Pivot-washer PW-N001-A + T-nut)

**HW-F003-A** Asym Uniback C-bolt Set  
(28-R2) (= T-nut + Step-Screw (M5\*14.8))

**VP-F002-A** NX2-Cable Mount-Set  
(27-G2) (= Cover + Washers + Tnut + Screw HW-F006-A (M5\*9))

**TL-F002-A** LSR2.0 Straight Toe-ladder w/o plug

**VP-F001-A** NX2 Toeladder Mount-Set  
(34-C2) (= Cover + T-nut + Screw HW-F006-A (M5\*9))

**MD-F003-A** Multi-Disk Alu Mounting Set (= Disk + Mount-screws HW-F016-A (M6\*13))

LSR2.0 Ankle-ratchet w/ screws (HW-N007-A)

**AB-N003-A**

ExoKush 2.0 Fusion Straps Set (= Ankle & Toe Spines + Exo2.0 Frame + Kush2.0 EVA + QS-latches)

**FS-F005-A**

LSR2.0 Toe-ratchet w/ screws (HW-N007-A)

**TB-N003-A**

EXO Buckle-mounting Screw (M5\*12.5)

**HW-N007-A**  
(24-C1)

QuickSet Pivot Ankle-ladder

**AQ-N001-A**  
(17-G1)

QuickSet Toe-ladder

**TQ-N002-A**  
(17-E1)

NX2 Series Baseplate Set (= Baseplate + OC-Kush Basepad)

**BP-F005-A**  
(01-R1)

NX2 Slip-N-Grip BankBed footbed Set

**FB-F003-A**  
(08-J1)

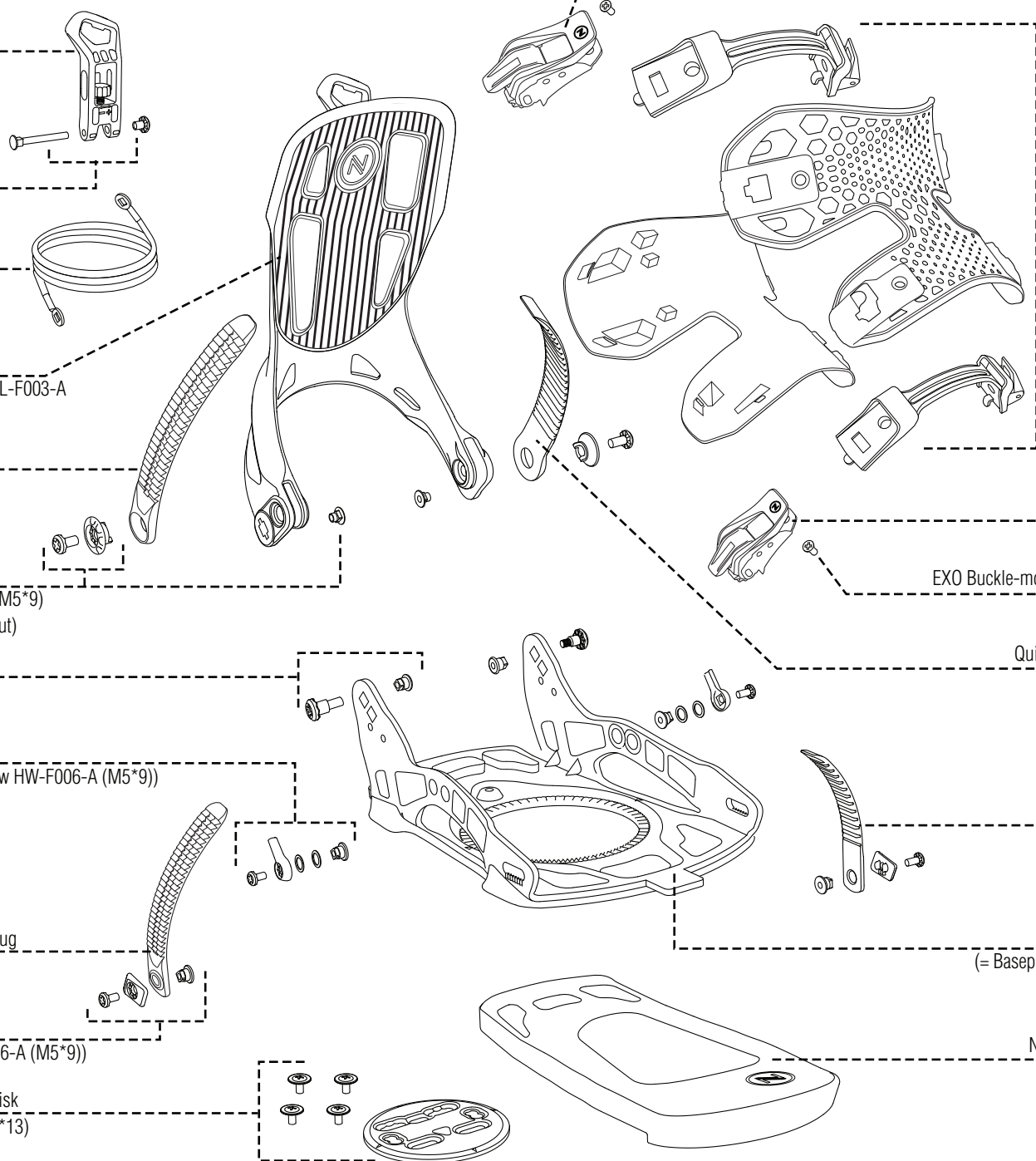

**SL-F003-A** Fuse/NX2 Snaplock  
(12-F1) w/ Bolt+Nut Set (HW-F014-A)

**HW-F014-A** Snaplock Mount Bolt+Nut Set  
(48-D2) (for Nylon hiback)

**CS-F004-A** NX2-CX Cable  
(14-01)

**HB-F002-A** Nylon Asym hiback Set  
(02-F3) (= Hiback + EVA + Snaplock Set SL-F003-A + C-bolt Set HW-F003-A)

**AL-N002-A** LSR2.0 Ankle Pivot-Ladder

**HW-F005-A** NX2/Fuse Ankle-ladder Pivot-mount Set (= Screw HW-F006-A (M5\*9) + Pivot-washer PW-N001-A + T-nut)

**HW-F003-A** Asym Uniback C-bolt Set  
(28-R2) (= T-nut + Step-Screw (M5\*14.8))

**VP-F002-A** NX2-Cable Mount-Set  
(27-G2) (= Cover + Washers + Tnut + Screw HW-F006-A (M5\*9))

**TL-F002-A** LSR2.0 Straight Toe-ladder w/o plug

**VP-F001-A** NX2 Toeladder Mount-Set  
(34-C2) (= Cover + T-nut + Screw HW-F006-A (M5\*9))

**MD-F003-A** Multi-Disk Alu Mounting Set (= Disk + Mount-screws HW-F016-A (M6\*13))

LSR2.0 Ankle-ratchet w/ screws (HW-N007-A)

**AB-N003-A**

ExoKush 2.0 Hybrid Straps Set (= Hybrid-Spine + Exo2.0 Hybrid-Frame + Kush2.0 Hybrid-EVA + QS-latches)

**HS-N003-A**

QuickSet Pivot Ankle-ladder

**AQ-N001-A**  
(17-G1)

LSR2.0 Toe-ratchet w/ screws (HW-N006-A)

**TB-N003-A**

Buckle-mounting Screw (M5\*7)

**HW-N006-A**  
(24-B1)

Hexo Toecap w/ QS-latch

**TS-N001-A**  
(11-A1)

QuickSet Y Toeladder

**YQ-N002-A**  
(17-J2)

NX2 Series Baseplate Set (= Baseplate + OC-Kush Basepad)

**BP-F005-A**  
(01-R1)

NX2 Slip-N-Grip BankBed footbed Set

**FB-F003-A**  
(08-J1)

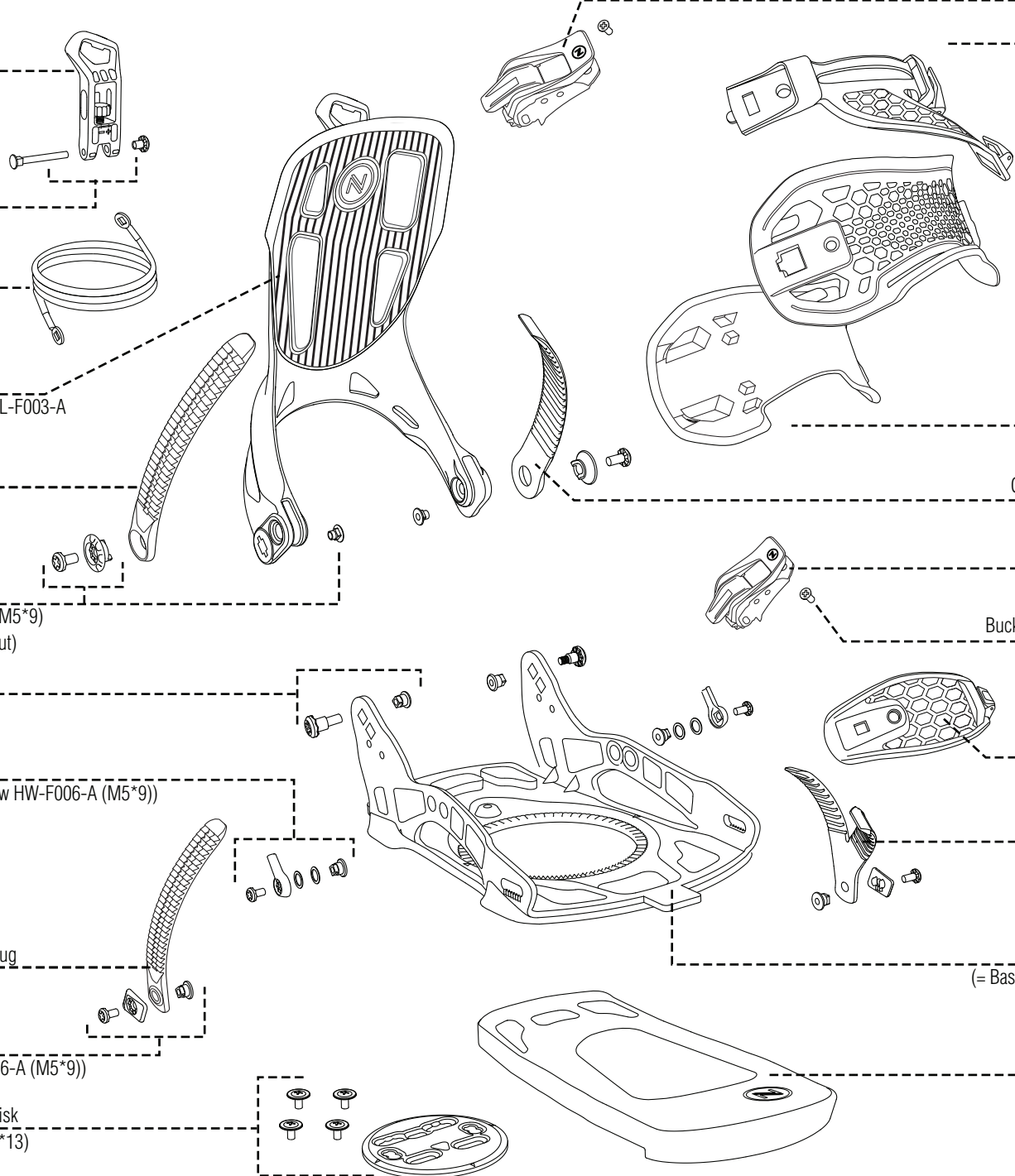

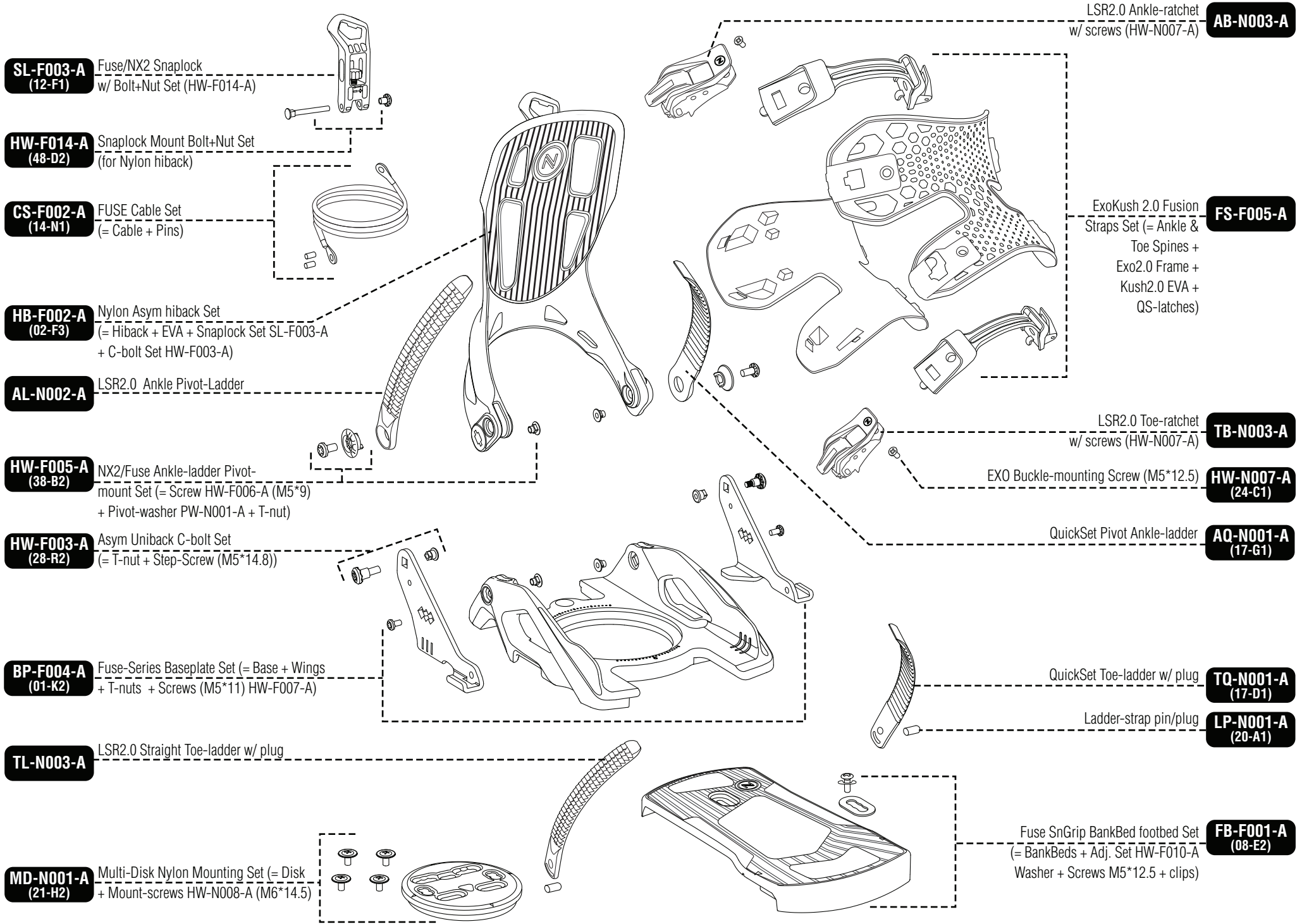

**SL-F003-A** Fuse/NX2 Snaplock  
(12-F1) w/ Bolt+Nut Set (HW-F014-A)

**HW-F014-A** Snaplock Mount Bolt+Nut Set  
(48-D2) (for Nylon hiback)

**CS-F002-A** FUSE Cable Set  
(14-N1) (= Cable + Pins)

**HB-F002-A** Nylon Asym hiback Set  
(02-F3) (= Hiback + EVA + Snaplock Set SL-F003-A + C-bolt Set HW-F003-A)

**AL-N002-A** LSR2.0 Ankle Pivot-Ladder

**HW-F005-A** NX2/Fuse Ankle-ladder Pivot-mount Set  
(38-B2) (= Screw HW-F006-A (M5\*9) + Pivot-washer PW-N001-A + T-nut)

**HW-F003-A** Asym Uniback C-bolt Set  
(28-R2) (= T-nut + Step-Screw (M5\*14.8))

**BP-F004-A** Fuse-Series Baseplate Set (= Base + Wings  
(01-K2) + T-nuts + Screws (M5\*11) HW-F007-A)

**TL-N003-A** LSR2.0 Straight Toe-ladder w/ plug

**MD-N001-A** Multi-Disk Nylon Mounting Set (= Disk  
(21-H2) + Mount-screws HW-N008-A (M6\*14.5))

LSR2.0 Ankle-ratchet  
w/ screws (HW-N007-A)

**AB-N003-A**

ExoKush 2.0 Hybrid  
Straps Set  
(= Hybrid-Spine +  
Exo2.0 Hybrid-Frame +  
Kush2.0 Hybrid-EVA +  
QS-latches)

**HS-N003-A**

QuickSet Pivot Ankle-ladder

**AQ-N001-A**  
(17-G1)

LSR2.0 Toe-ratchet  
w/ screws (HW-N006-A)

**TB-N003-A**

Buckle-mounting Screw (M5\*7)

**HW-N006-A**  
(24-B1)

Hexo Toecap w/ QS-latch

**TS-N001-A**  
(11-A1)

QuickSet Y Toeladder w/ plug

**YQ-N001-A**  
(17-H2)

Ladder-strap pin/plug

**LP-N001-A**  
(20-A1)

Fuse SnGrip BankBed footbed Set  
(= BankBeds + Adj. Set HW-F010-A  
Washer + Screws M5\*12.5 + clips)

**FB-F001-A**  
(08-E2)

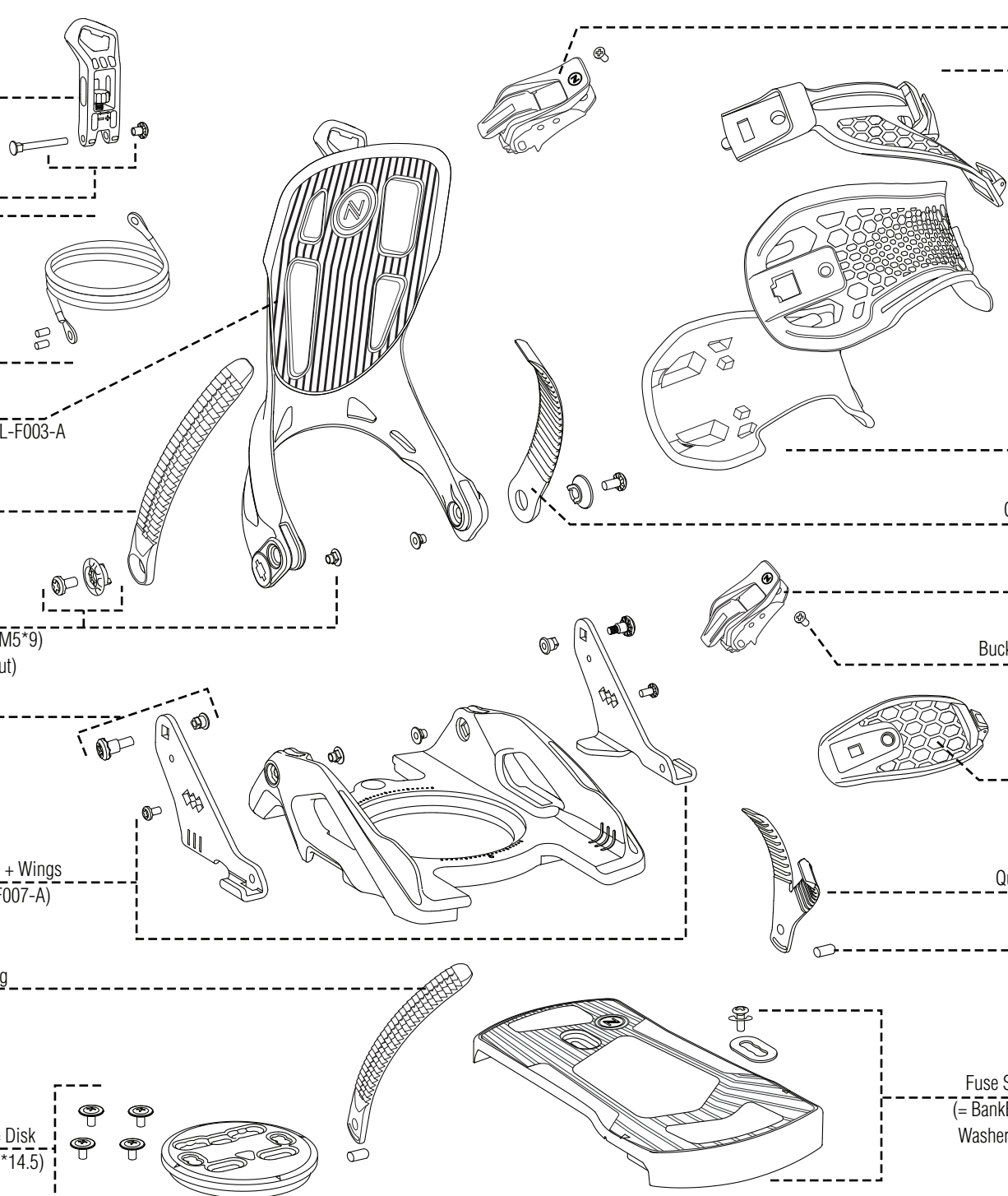



**SL-F002-A** Axis Snaplock Set  
(12-J1)  
(= Snaplock +  
Pin w/ clips HW-F013-A)

**CS-F001-A** Axis-series Cable Set (= Cable  
(14-P1)  
+ U-mount HW-F011-A  
+ Pin-Mount HW-F012-A)

**HB-F004-A** Axis-FNX UniBack hiback Set  
(02-H1)  
(= Hiback + Eva + Snaplock-Set SL-F002-A  
+ C-bolt-Set HW-F002-A)

**HW-F002-A** Axis-FNX C-bolt Set (= Bolt  
(28-U2)  
+ Screw (M5\*12) HW-F008-A  
+ Pivotwasher PW-F001-A)

**AL-F002-A** Axis LSR Ankle-Pivot-ladder  
(18-G1)

**BP-F003-A** Axis-Series FNX Baseplate  
(01-N1)

**TL-N001-A** LSR Toe-ladder w/ plug  
(18-A1)

**MD-N001-A** Multi-Disk Mounting Set (= Disk  
(21-H2)  
+ Mount-Screws HW-N008-A (M6\*14.5))

LSR Ankle-buckle w/ screws (HW-N007-A)

**AB-N002-A**  
(41-D3)

Fusion ExoFrame Set  
(= ExoFrame + AnkleSpine  
+ ToeSpine + QS-latches)

**FS-F003-A**  
(11-F1)

LSR Toe-buckle  
w/ screws (HW-N007-A)

**TB-N002-A**  
(41-E3)

EXO Buckle-mounting Screw (M5\*12.5)

**HW-N007-A**  
(24-C1)

Axis QuickSet Ankle-Pivot-ladder

**AQ-F001-A**  
(17-K1)

QuickSet Toe-ladder w/ plug

**TQ-N001-A**  
(17-D1)

Ladder-strap pin/plug

**LP-N001-A**  
(20-A1)

Axis-KAON/FENIX Baseplate-Cushioning set  
(=Bankbed + Heel-basepad + Rocker-EVA)

**FB-N002-A**  
(N08-A1)

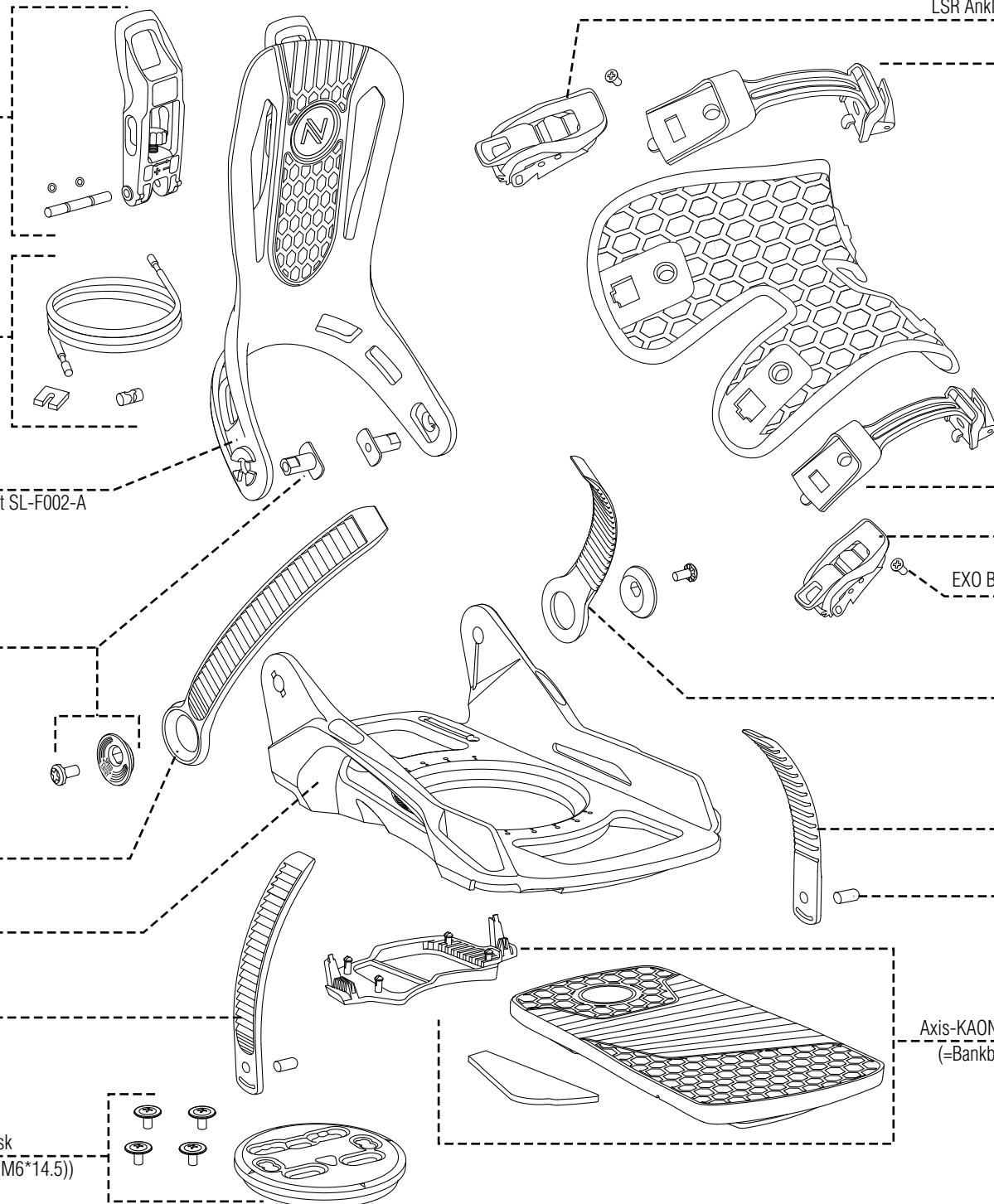

**SL-F002-A** Axis Snaplock Set  
(12-J1)  
(= Snaplock +  
Pin w/ clips HW-F013-A)

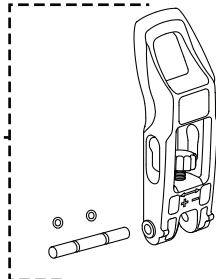

**CS-F001-A** Axis-series Cable Set (= Cable  
(14-P1)  
+ U-mount HW-F011-A  
+ Pin-Mount HW-F012-A)

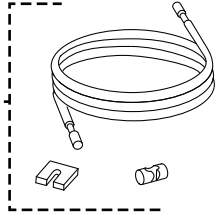

**HB-F005-A** Axis-NXS UniBack hiback Set  
(02-G3)  
(= Hiback + Eva + Snaplock-Set SL-F002-A  
+ C-bolt-Set HW-F026-A)



**HW-F017-A** Axis-NXS C-bolt Set (= Bolt  
(28-T3)  
+ Screw (M5\*12) HW-F018-A  
+ Pivotwasher PW-N001-A)

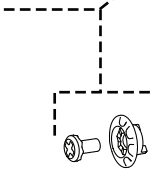

**AL-N001-A** LSR Pivot Ankle-ladder  
(18-F1)

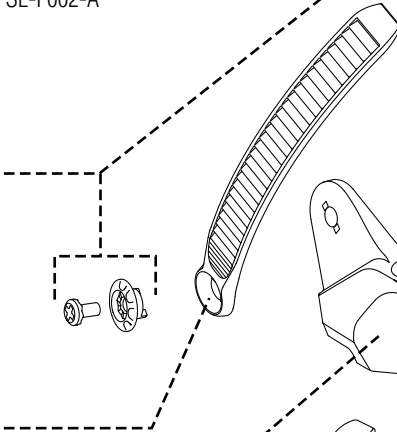

**BP-F002-A** Axis-Series NXS Baseplate  
(01-P1)

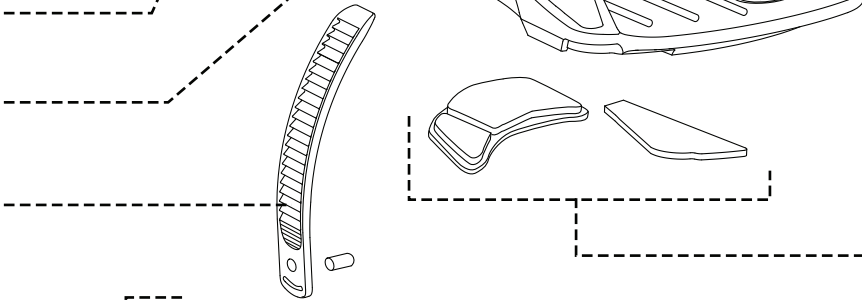

**TL-N001-A** LSR Toe-ladder w/ plug  
(18-A1)

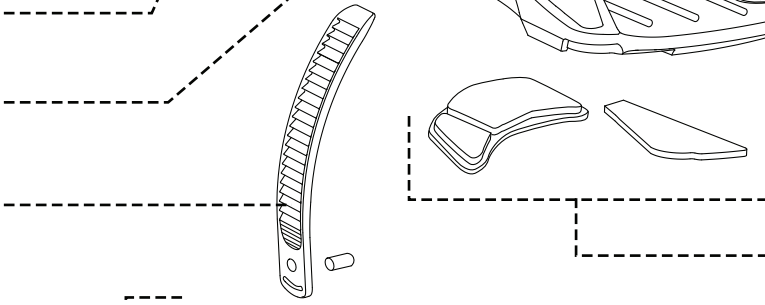

**MD-N001-A** Multi-Disk Mounting Set (= Disk  
(21-H2)  
+ Mount-Screws HW-N008-A (M6\*14.5))

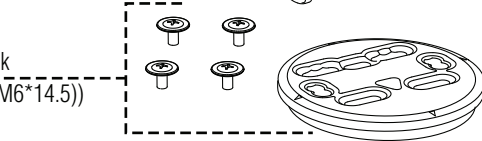

LSR Ankle-buckle w/ screws (HW-N006-A) **AB-N002-A**  
(41-D3)

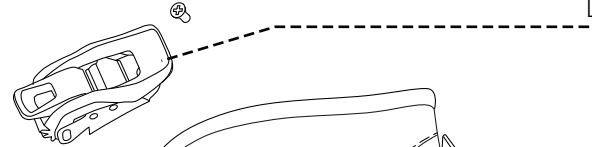

Fusion PowerStrap set **FS-F002-A**  
w/ QS-Latches (09-J2)

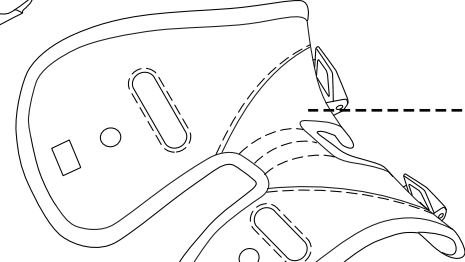

Buckle-mounting Screw (M5\*7) **HW-N006-A**  
(24-B1)



LSR Toe-buckle w/ screws (HW-N006-A) **TB-N002-A**  
(41-E3)

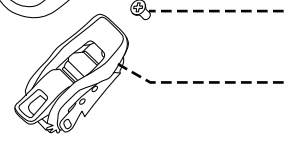

QuickSet Pivot Ankle-ladder **AQ-N001-A**  
(17-G1)

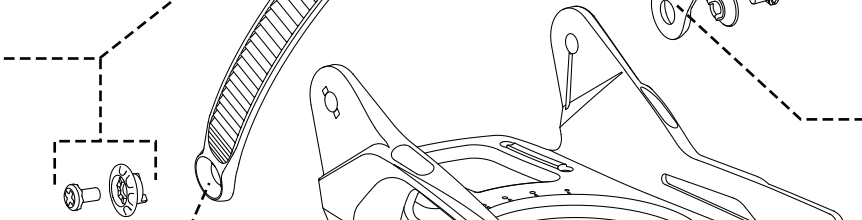

QuickSet Toe-ladder w/ plug **TQ-N001-A**  
(17-D1)



Ladder-strap pin/plug **LP-N001-A**  
(20-A1)



Axis-MUON/NEXUS Baseplate-Cushioning set **FB-N001-A**  
(= Heel-EVA + Rocker-EVA) (08-C1)

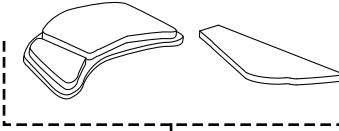

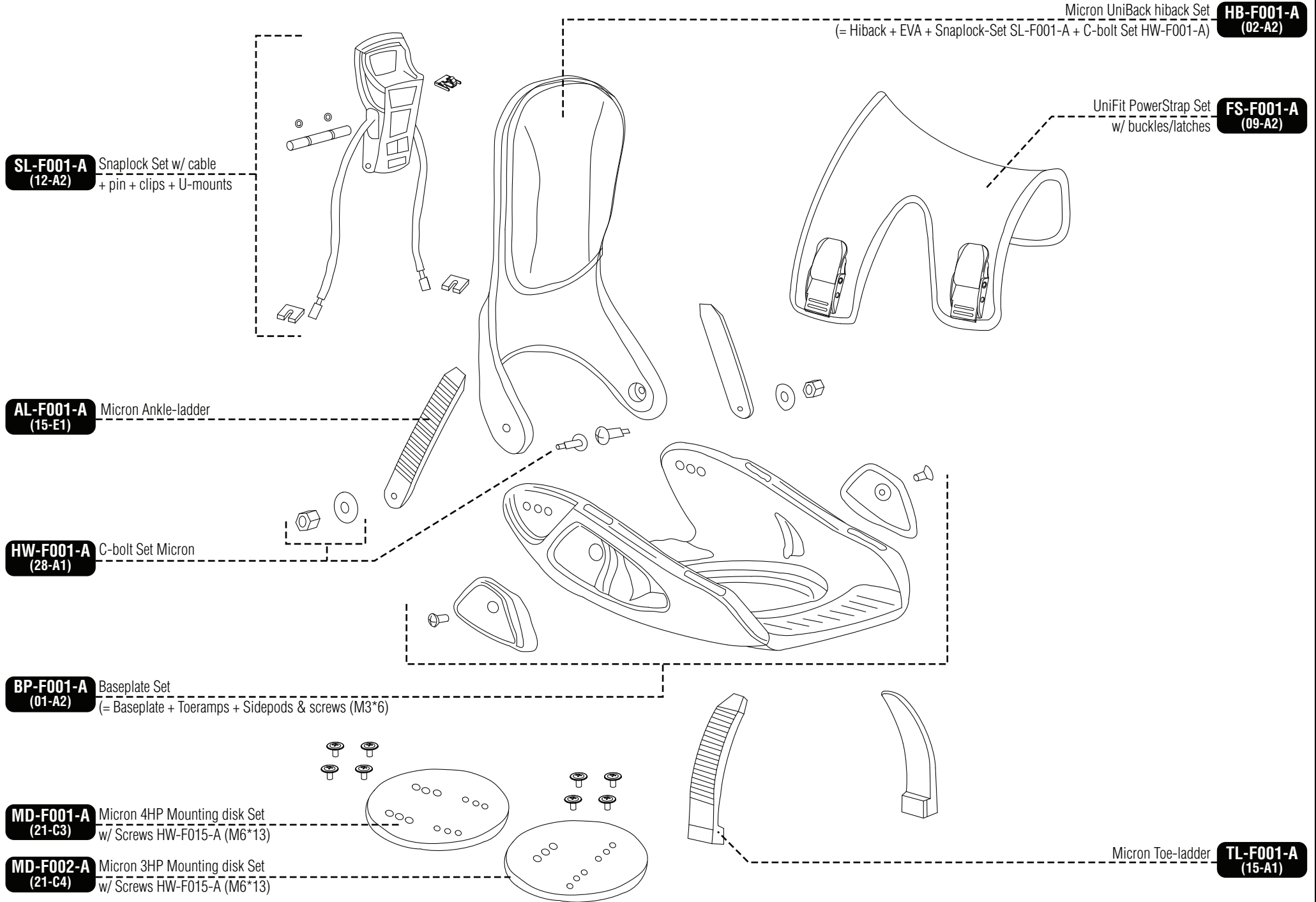

**FL-N002-A** Meson FWD-lean Set  
(= Lean-Lever + hardware)

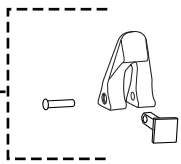

**HB-N004-A** Meson PRO Hiback Set  
(= Hiback + EVA-pads  
+ FWD-lean FL-N002-A assembled)

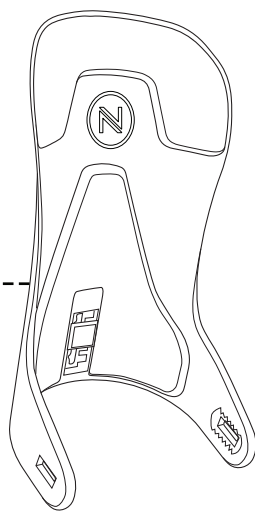

Axion Ankle-ratchet w/ screws (HW-N007-A) **AB-N001-A (N41-K1)**

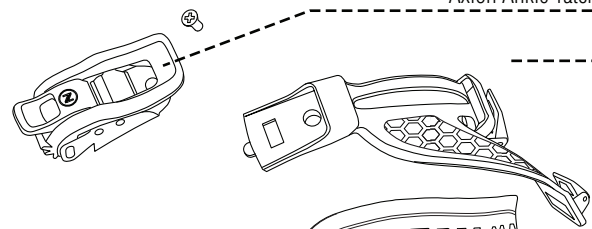

**HS-N003-A** ExoKush 2.0 Hybrid Straps Set  
(= Hybrid-Spine + Exo2.0 Hybrid-Frame + Kush2.0 Hybrid-EVA + QS-latches)

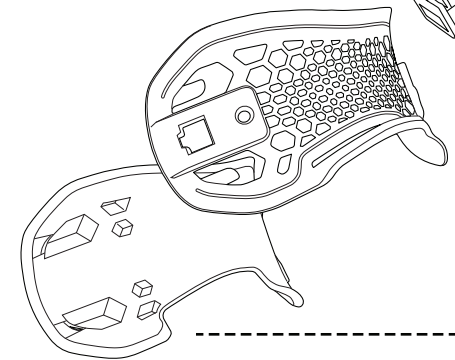

**AL-N001-A (18-F1)** LSR Pivot Ankle-ladder

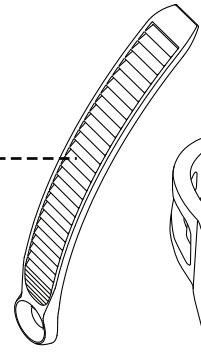

QuickSet Pivot Ankle-ladder **AQ-N001-A (17-G1)**

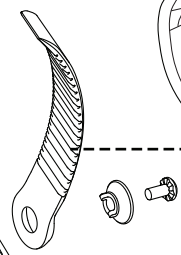

**HW-N003-A** Axis/Meson C-bolt Set  
(= Screw M5\*22 + T-nut  
+ Pivot-Washer PW-N001-A)

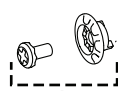

Axion Toe-ratchet w/ screws (HW-N006-A) **TB-N001-A (N41-L1)**

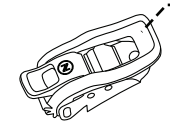

Buckle-mounting Screw (M5\*7) **HW-N006-A (24-B1)**

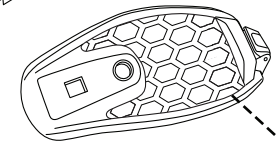

**BP-N003-A (N01-G1)** Axis.N1-Series Kaon Baseplate+Heelcup

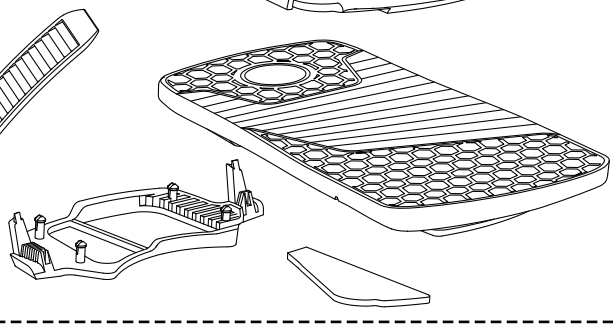

Hexo Toecap w/ QS-latch **TS-N001-A (11-A1)**

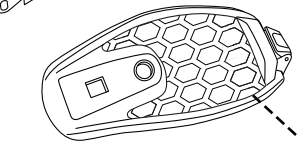

**TL-N001-A (18-A1)** LSR Toe-ladder w/ plug

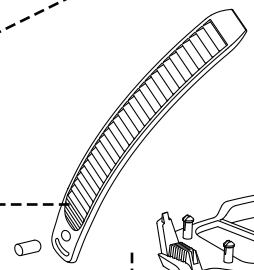

QuickSet Y Toeladder w/ plug **YQ-N001-A (17-H2)**

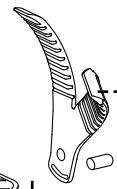

Ladder-strap pin/plug **LP-N001-A (20-A1)**

Axis-KAON/FENIX Baseplate-Cushioning set  
(= Bankbed + Heel-basepad + Rocker-EVA) **FB-N002-A (N08-A1)**

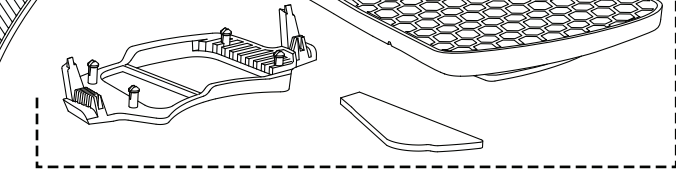

**MD-N001-A (21-H2)** Multi-Disk Mounting Set (= Disk  
+ Mount-Screws HW-N008-A (M6\*14.5))

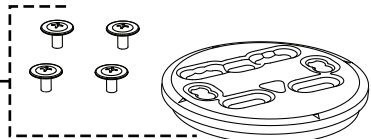



**FL-N002-A** Meson FWD-lean Set  
(= Lean-Lever + hardware)

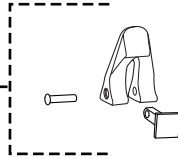

**HB-N005-A** Meson Hiback Set  
(= Hiback + EVA-pads  
+ FWD-lean FL-N002-A assembled)

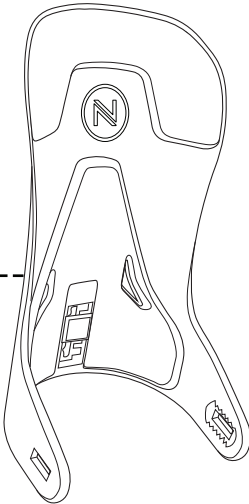

Axion Ankle-ratchet w/ screws (HW-N007-A)

**AB-N001-A**  
(N41-K1)

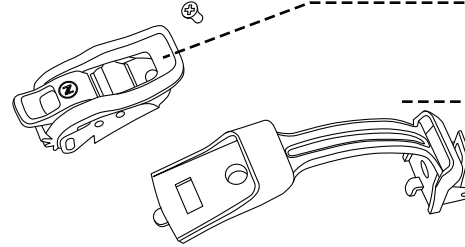

Ankle ExoFrame Set  
(= AnkleSpine +  
ExoFrame strap +  
QuickSet latch)

**AS-N002-A**  
(N11-B1)

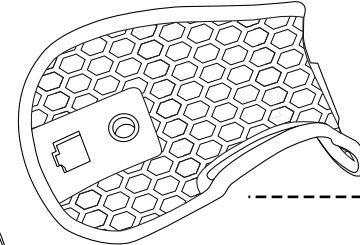

**AL-N001-A** LSR Pivot Ankle-ladder  
(18-F1)

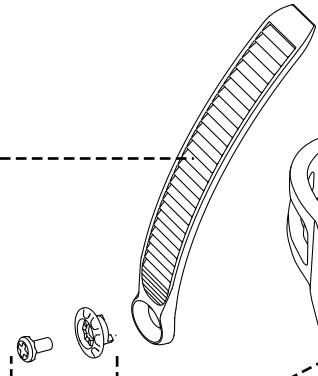

QuickSet Pivot Ankle-ladder

**AQ-N001-A**  
(17-G1)

Axion Toe-ratchet w/ screws (HW-N006-A)

**TB-N001-A**  
(N41-L1)

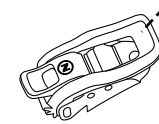

Buckle-mounting Screw (M5\*7)

**HW-N006-A**  
(24-B1)

**HW-N003-A** Axis/Meson C-bolt Set  
(= Screw M5\*22 + T-nut  
+ Pivot-Washer PW-N001-A)

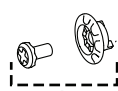

Hexo Toecap w/ QS-latch

**TS-N001-A**  
(11-A1)

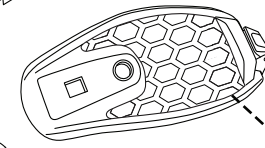

**BP-N003-A** Axis.N1-Series Kaon Baseplate+Heelcup  
(N01-G1)

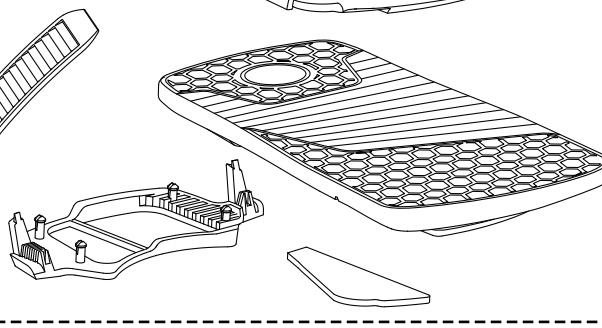

QuickSet Toe-ladder w/ plug

**TQ-N001-A**  
(17-D1)

**TL-N001-A** LSR Toe-ladder w/ plug  
(18-A1)

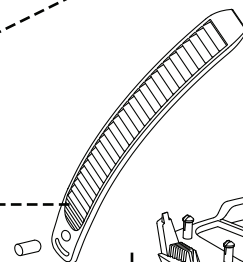

Ladder-strap pin/plug

**LP-N001-A**  
(20-A1)



Axis-KAON/FENIX Baseplate-Cushioning set  
(= Bankbed + Heel-basepad + Rocker-EVA)

**FB-N002-A**  
(N08-A1)

**MD-N001-A** Multi-Disk Mounting Set (= Disk  
(21-H2) + Mount-Screws HW-N008-A (M6\*14.5))

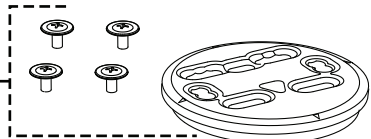

**FL-N001-A** Hadron FWD-lean Set  
(N12-K2)  
(= Lean-block + Lever + hardware)

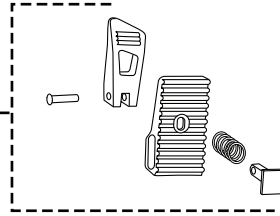

**HB-N002-A** Asym Hadron Hiback Set  
(N02-F2)  
(= Hiback + EVA-pad  
+ FWD-lean FL-N001-A assembled)

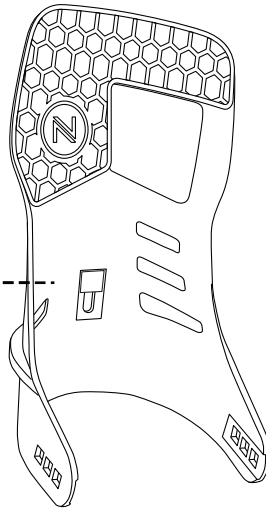

Axion Ankle-ratchet w/ screws (HW-N006-A) **AB-N001-A**  
(N41-K1)

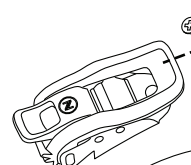

Ankle ComfortFit-strap w/ QS-latch **AS-N001-A**  
(N11-A1)

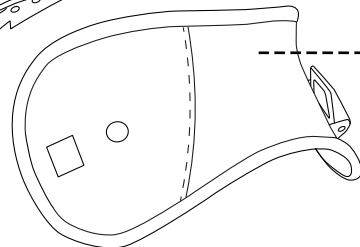

**AL-N001-A** LSR Pivot Ankle-ladder  
(18-F1)

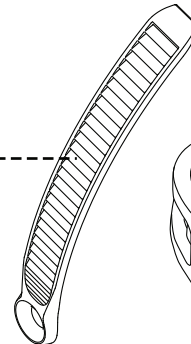

QuickSet Pivot Ankle-ladder **AQ-N001-A**  
(17-G1)

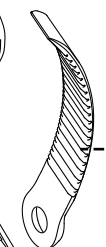

Axion Toe-ratchet w/ screws (HW-N006-A) **TB-N001-A**  
(N41-L1)

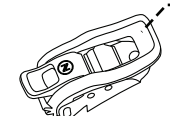

Buckle-mounting Screw (M5\*7) **HW-N006-A**  
(24-B1)

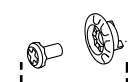

**HW-N001-A** Axis.N1 C-bolt Set  
(N28-F1)  
(= Screw M5\*22 + T-nut  
+ Pivot-Washer PW-N001-A)

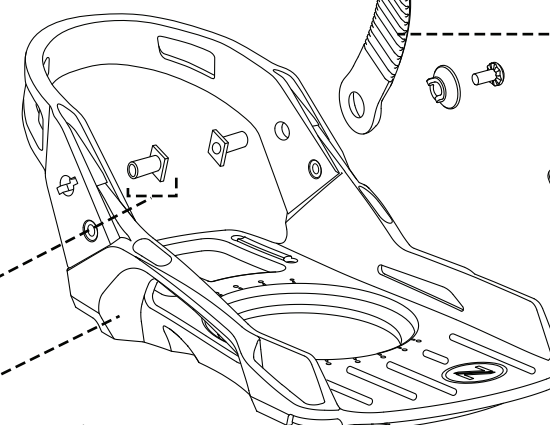

Hexo Toecap w/ QS-latch **TS-N001-A**  
(11-A1)

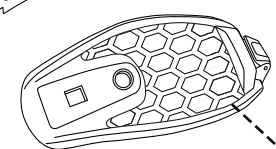

**BP-N002-A** Axis.N1-Series Muon Baseplate+Heelcup  
(N01-F1)

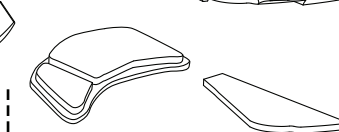

QuickSet Toe-ladder w/ plug **TQ-N001-A**  
(17-D1)

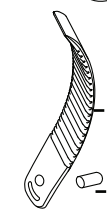

**TL-N001-A** LSR Toe-ladder w/ plug  
(18-A1)

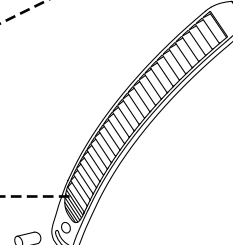

Ladder-strap pin/plug **LP-N001-A**  
(20-A1)



Axis-MUON/NEXUS Baseplate-Cushioning set **FB-N001-A**  
(= Heel-EVA + Rocker-EVA) (08-C1)

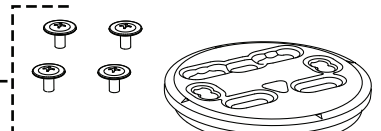

**MD-N001-A** Multi-Disk Mounting Set (= Disk  
(21-H2)  
+ Mount-Screws HW-N008-A (M6\*14.5))

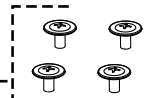

**FL-N001-A** Hadron FWD-lean Set  
(N12-K2)  
(= Lean-block + Lever + hardware)

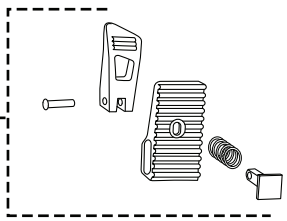

**HB-N002-A** Asym Hadron Hiback Set  
(N02-F2)  
(= Hiback + EVA-pad + FWD-lean FL-N001-A assembled)

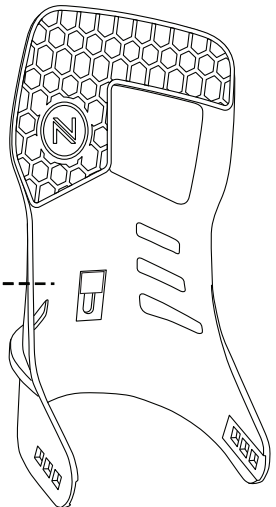

Axion Ankle-ratchet w/ screws (HW-N007-A)

**AB-N001-A**  
(N41-K1)

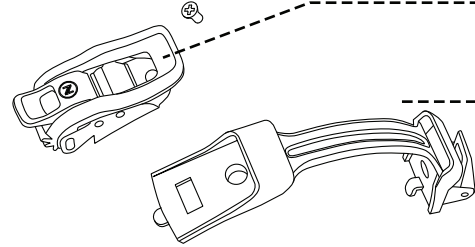

Ankle ExoFrame Set  
(= AnkleSpine + ExoFrame strap + QuickSet latch)

**AS-N002-A**  
(N11-B1)

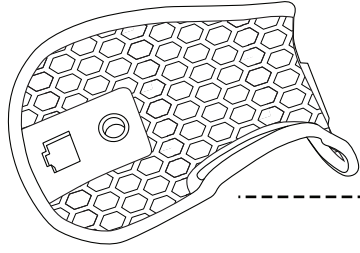

**AL-N001-A** LSR Pivot Ankle-ladder  
(18-F1)

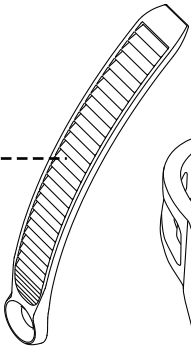

QuickSet Pivot Ankle-ladder

**AQ-N001-A**  
(17-G1)



**HW-N001-A** Axis.N1 C-bolt Set  
(N28-F1)  
(= Screw M5\*22 + T-nut + Pivot-Washer PW-N001-A)

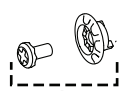

Axion Toe-ratchet w/ screws (HW-N006-A)

**TB-N001-A**  
(N41-L1)

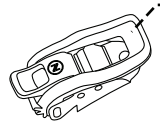

Buckle-mounting Screw (M5\*7)

**HW-N006-A**  
(24-B1)

**BP-N002-A** Axis.N1-Series Muon Baseplate+Heelcup  
(N01-F1)

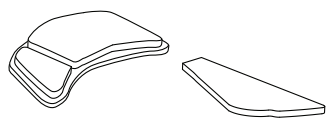

Hexo Toecap w/ QS-latch

**TS-N001-A**  
(11-A1)

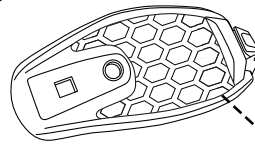

QuickSet Toe-ladder w/ plug

**TQ-N001-A**  
(17-D1)

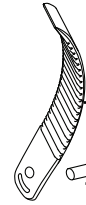

**TL-N001-A** LSR Toe-ladder w/ plug  
(18-A1)

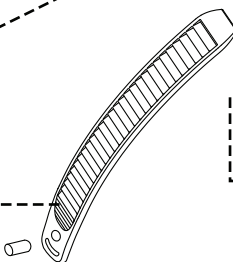

Ladder-strap pin/plug

**LP-N001-A**  
(20-A1)



Axis-MUON/NEXUS Baseplate-Cushioning set  
(= Heel-EVA + Rocker-EVA)

**FB-N001-A**  
(08-C1)

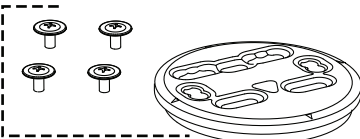

**MD-N001-A** Multi-Disk Mounting Set (= Disk + Mount-Screws HW-N008-A (M6\*14.5))  
(21-H2)

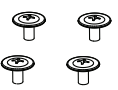

**HB-N001-A**  
(N02-H1) Magic Hiback

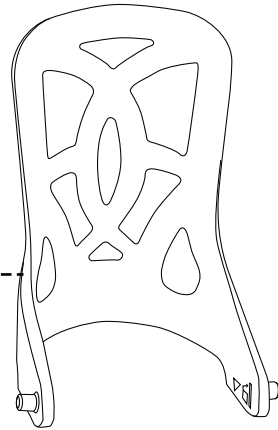

**AL-N003-A**  
(N18-M1) Magic Ankle-ladder

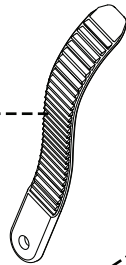

**AL-N004-A**  
(N19-A1) Magic Ankle-ladder Pods



**BP-N001-A**  
(N01-H1) Magic Baseplate Set  
(= w/ EVA-pad +  
Magic Mounting-hardware Set HW-N005-A)

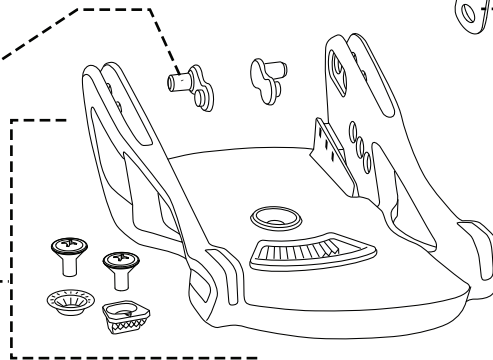

**TL-N004-A**  
(N18-N1) Magic Toe-ladder w/ plug

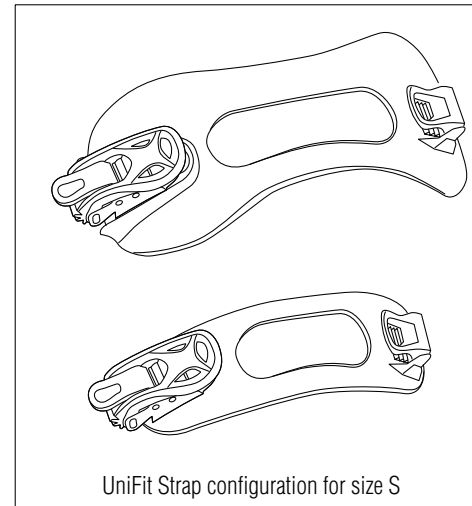
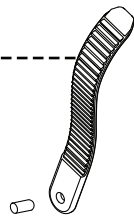

UniFit Strap-Set  
w/ Atom-Ratchets **SS-N002-A**  
(N11-E1)

Magic Ankle-connector **AQ-N002-A**  
(N17-K1)

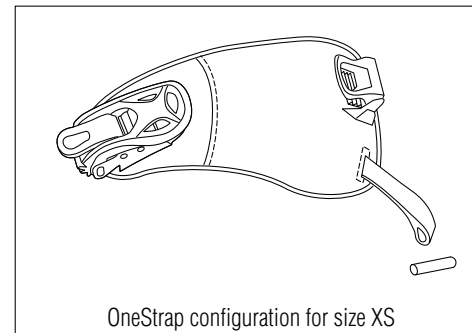

Magic Toe-connector w/ plug **TQ-N003-A**  
(N17-L1)

OneStrap set  
w/ Atom-Ratchet + pin **SS-N001-A**  
(N11-D1)



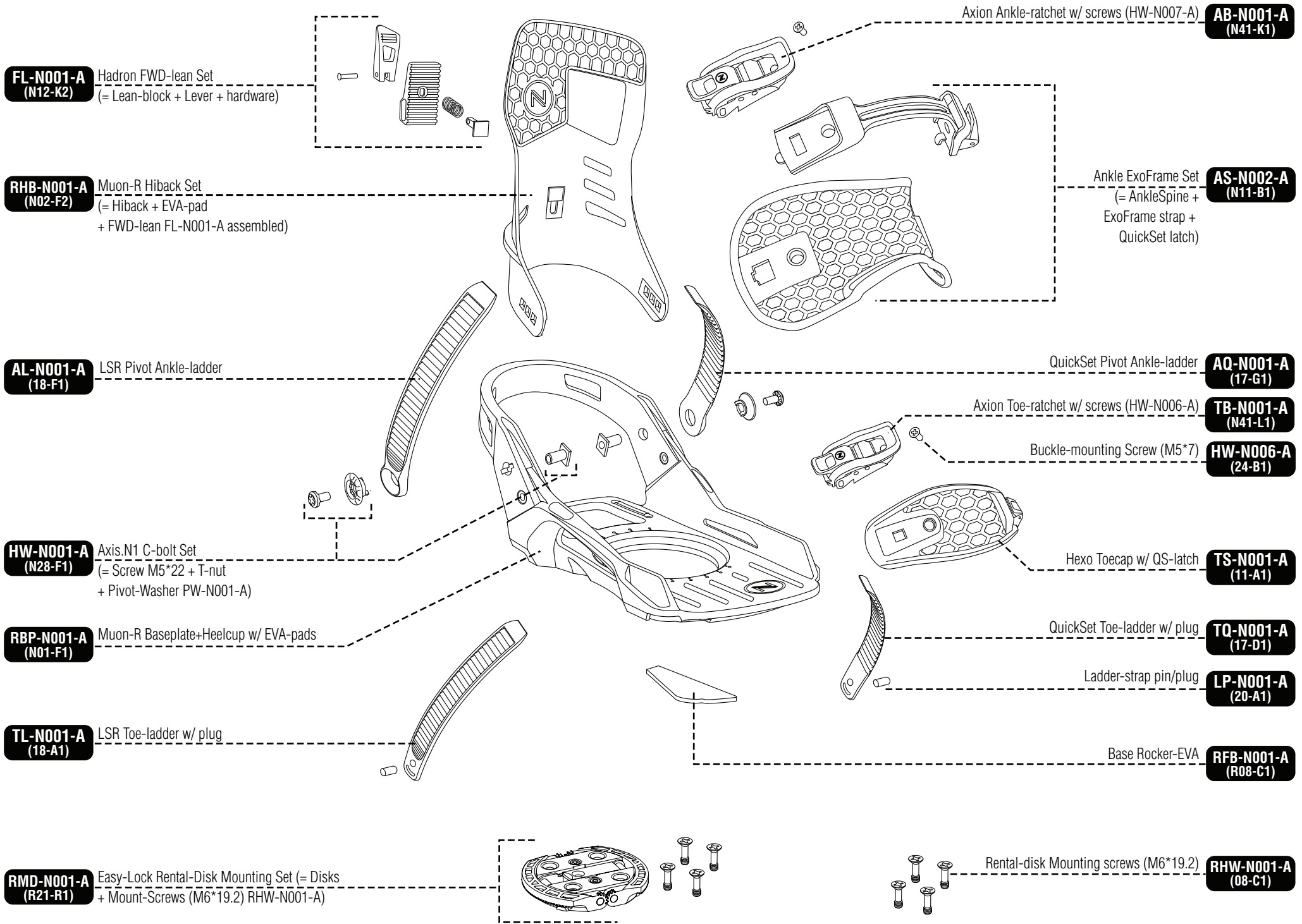

**FL-N001-A** (N12-K2) Hadron FWD-lean Set  
(= Lean-block + Lever + hardware)

**RHB-N001-A** (N02-F2) Muon-R Hiback Set  
(= Hiback + EVA-pad + FWD-lean FL-N001-A assembled)

**AL-N001-A** (18-F1) LSR Pivot Ankle-ladder

**HW-N001-A** (N28-F1) Axis.N1 C-bolt Set  
(= Screw M5\*22 + T-nut + Pivot-Washer PW-N001-A)

**RBP-N001-A** (N01-F1) Muon-R Baseplate+Heelcup w/ EVA-pads

**TL-N001-A** (18-A1) LSR Toe-ladder w/ plug

**RMD-N001-A** (R21-R1) Easy-Lock Rental-Disk Mounting Set (= Disks + Mount-Screws (M6\*19.2) RHW-N001-A)

Axion Ankle-ratchet w/ screws (HW-N007-A) **AB-N001-A** (N41-K1)

Ankle ExoFrame Set **AS-N002-A** (N11-B1)  
(= AnkleSpine + ExoFrame strap + QuickSet latch)

QuickSet Pivot Ankle-ladder **AQ-N001-A** (17-G1)

Axion Toe-ratchet w/ screws (HW-N006-A) **TB-N001-A** (N41-L1)

Buckle-mounting Screw (M5\*7) **HW-N006-A** (24-B1)

Hexo Toecap w/ QS-latch **TS-N001-A** (11-A1)

QuickSet Toe-ladder w/ plug **TQ-N001-A** (17-D1)

Ladder-strap pin/plug **LP-N001-A** (20-A1)

Base Rocker-EVA **RFB-N001-A** (R08-C1)

Rental-disk Mounting screws (M6\*19.2) **RHW-N001-A** (08-C1)

**SL-F002-A**  
(12-J1)  
Axis Snaplock Set  
(= Snaplock +  
Pin w/ clips HW-F013-A)

**CS-F001-A**  
(14-P1)  
Axis-series Cable Set (= Cable  
+ U-mount HW-F011-A  
+ Pin-Mount HW-F012-A)

**RHB-F001-A**  
(R02-H1)  
Nexus-R hiback Set  
(= Hiback + Eva + Snaplock-Set SL-F002-A  
+ C-bolt-Set HW-F002-A)

**HW-F002-A**  
(28-U2)  
Axis-FNX C-bolt Set (= Bolt  
+ Screw (M5\*12) HW-F018-A  
+ Pivotwasher PW-F001-A)

**AL-F002-A**  
(18-G1)  
Axis LSR Ankle-Pivot-ladder

**RBP-F001-A**  
(R01-P1)  
Nexus-R Baseplate

**TL-N001-A**  
(18-A1)  
LSR Toe-ladder w/ plug

**RMD-N001-A**  
(R21-R1)  
Easy-Lock Rental-Disk Mounting Set (= Disks  
+ Mount-Screws (M6\*19.2) RHW-N001-A)

LSR Ankle-buckle w/ screws (HW-N007-A) **AB-N002-A**  
(41-D3)

Fusion ExoFrame Set **FS-F003-A**  
(11-F1)  
(= ExoFrame + AnkleSpine  
+ ToeSpine + QS-latches)

LSR Toe-buckle w/ screws (HW-N007-A) **TB-N002-A**  
(41-E3)

EXO Buckle-mounting Screw (M5\*12.5) **HW-N007-A**  
(24-C1)

Axis QuickSet Ankle-Pivot-ladder **AQ-F001-A**  
(17-K1)

QuickSet Toe-ladder w/ plug **TQ-N001-A**  
(17-D1)

Ladder-strap pin/plug **LP-N001-A**  
(20-A1)

Base Rocker-EVA **RFB-N001-A**  
(R08-C1)

Rental-disk Mounting screws (M6\*19.2) **RHW-N001-A**  
(08-C1)

